

TM600. Enrich your farming.



TM600 Reliability at first sight.

The TM600 range has been developed combining extreme light-weight with outstanding strength. Metric and tubeless range ideal for medium power tractors.



Printed on
recycled paper

High traction capacity for maximum crop protection

The shape, geometry, number and depth of TM600 lug's have been carefully designed in order to guarantee high traction capability in all soil conditions.

The chart shows the high pull force of Trelleborg TM600 tires compared to the same sizes of premium brand competitors.

TRACTION IN FIELD
Slippage: 10-15%

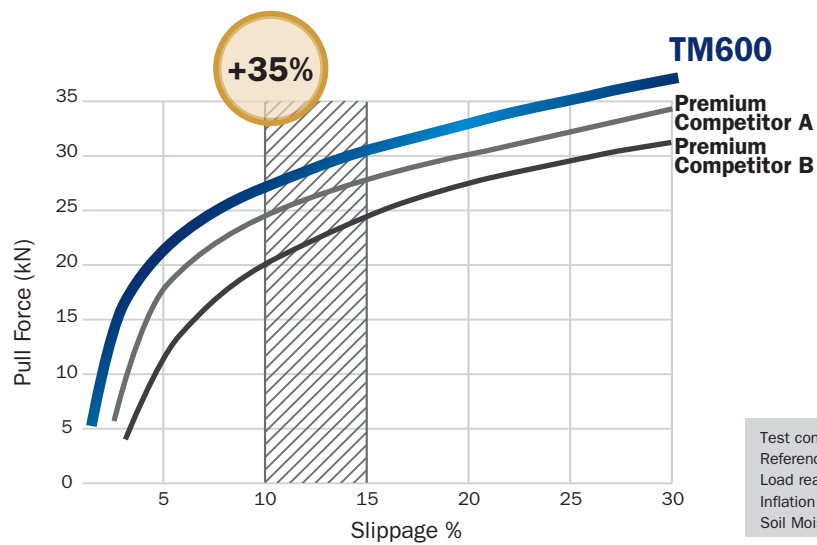

Minimum soil compaction, maximum lightness



TM600 ensures uniform soil penetration and high flotation performance, helping to reduce compaction, thus protecting the soil and enhancing fertility.

In order to achieve these benefits, the lug surface area has been designed to minimize the contact pressure value in the center of the tread.

FOOTPRINT AREA Size: 520/85R38 - Load: 3,875 kg

+24%

Higher is better



TM600
3,153 cm²



Premium Competitor A
2,758 cm²



Premium Competitor B
2,415 cm²

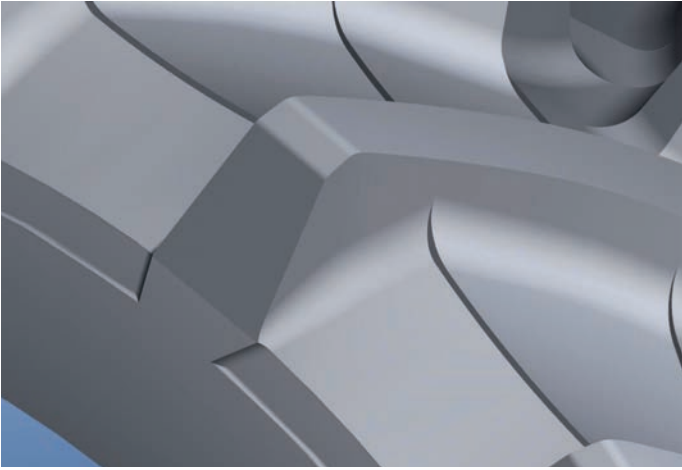

The rounded shoulder of the lug has been designed to lower damage to grass and crops to the minimum as well as maintaining good lateral stability and traction.

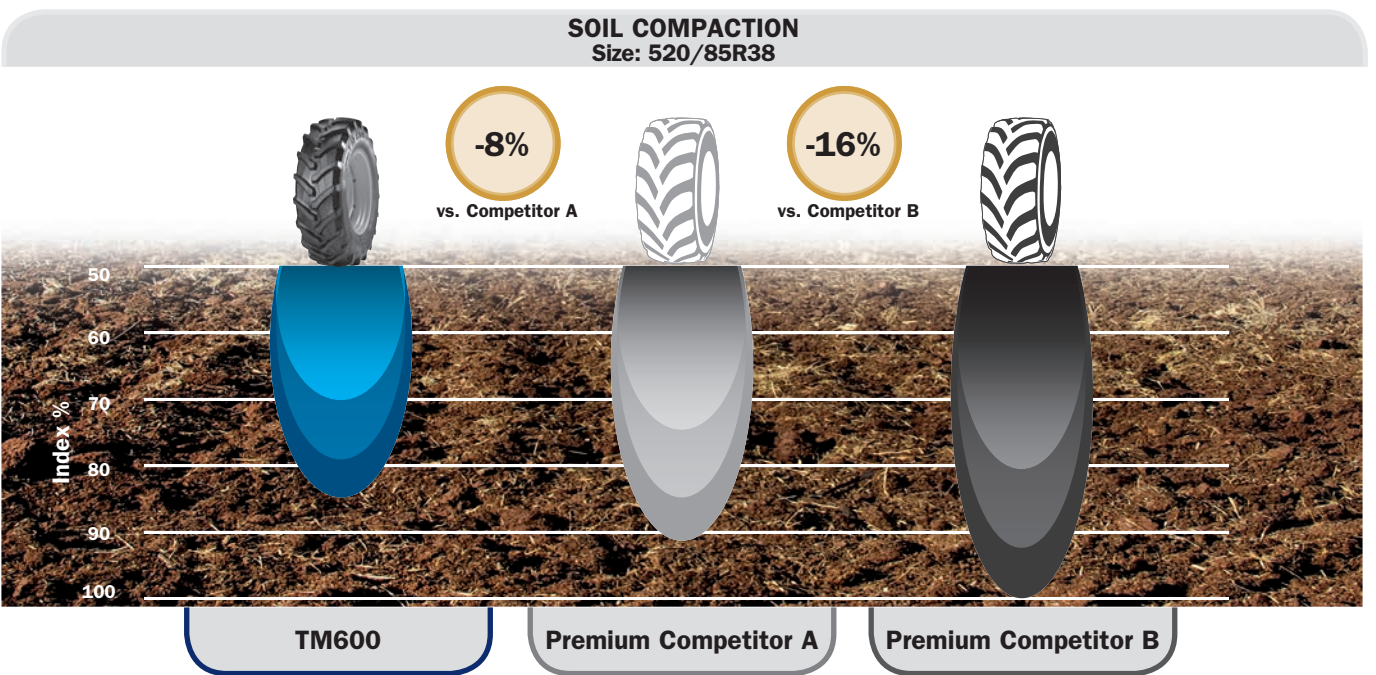

The geometry of the inter-lug terraces enhances the self-cleaning characteristics on muddy soil.



Exceptional comfort

Today tractors are increasingly used on the road moving quickly from one field to another, often carrying equipment or towing trailers. Over the years, TM600 has not only proved

great performance in the fields, but also on the road, ensuring high comfort throughout the complete lifetime of the tire.

COMFORT PERFORMANCE Size front: 380/85R28 - Size rear: 460/85R38

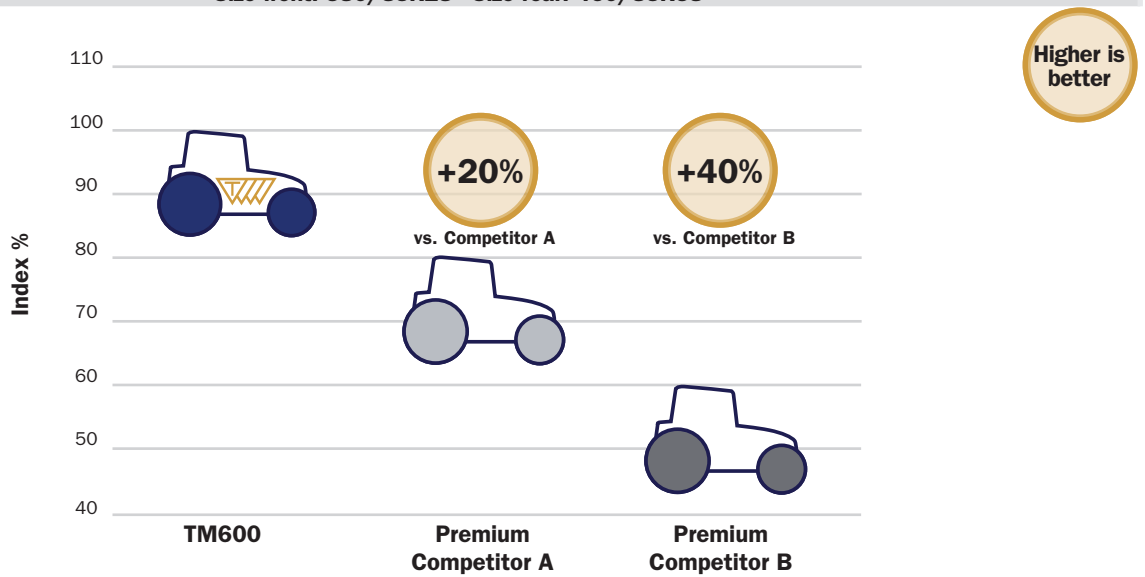

In addition to excellent comfort, TM600 has great handling performance in terms of steering and cornering stability.

Driver feeling is very good. Best handling among premium competitors.

HANDLING PERFORMANCE Size rear: 460/85R38

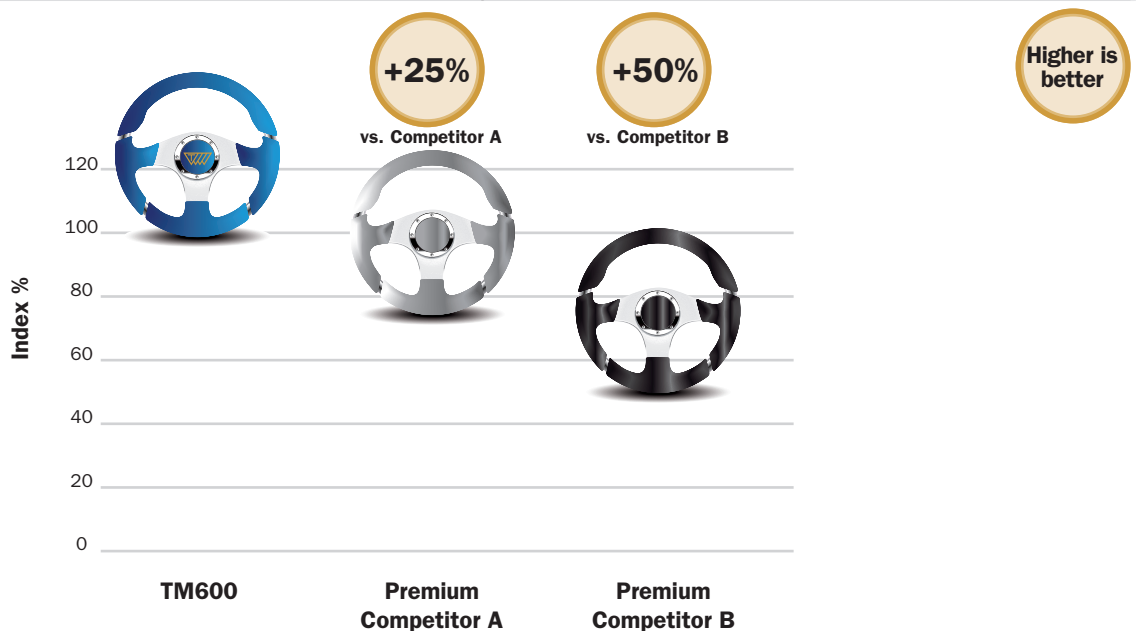

TM600

| | SIZE | Tread Pattern | SW mm | OD mm | SLR mm | RC mm | SRI | Rim | Permitted Rims | Type | Tube |
|------------|--|-----------------------------------|----------------|-------|--------|-------|------|-------|--------------------------------------|----------|-----------------------|
| | 210/95R16 106A8 (106B) | TM600 | 210 | 800 | 363 | 2415 | 390 | W7 | W6 - 5.50F | TUBELESS | |
| | 210/95R18 108A8 (108B) | TM600 | 210 | 855 | 391 | 2555 | 410 | W7 | W6 - 5.50F | TUBELESS | |
| | 280/85R20 112A8 (109B) (11.2R20) | TM600 | 295 | 985 | 450 | 2955 | 475 | W10 | W9 - W8 - DW10 | TUBELESS | 11.2-20 TR218 |
| | 320/85R20 119A8 (116B) (12.4R20) | TM600 | 329 | 1052 | 470 | 3160 | 500 | W11 | W10 - W9 - DW11 | TUBELESS | 11.2-20 TR218 |
| | 250/85R24 112A8 (109B) | TM600 | In preparation | | | | | | | | |
| | 280/85R24 115A8 (112B) (11.2R24) | TM600 | 292 | 1086 | 494 | 3276 | 525 | W10 | W9 - W8 - DW10 | TUBELESS | 11.2-24 TR218 |
| | 320/85R24 122A8 (119B) (12.4R24) | TM600 | 329 | 1154 | 515 | 3465 | 550 | W11 | W10 - W9 - DW10 DW11 | TUBELESS | 12.4/13.6-24 TR218 |
| | 340/85R24 125A8 (122B) (13.6R24) | TM600 | 353 | 1188 | 540 | 3547 | 575 | W12 | W11 - DW11 - DW12 | TUBELESS | 13.6/14.9-24 TR218 |
| | 380/85R24 131A8 (128B) (14.9R24) | TM600 | 390 | 1256 | 560 | 3750 | 600 | W13 | W12 - W11 - DW11 DW12 - DW13 | TUBELESS | 14.9/16.9-24 TR218 |
| | 420/85R24 137A8 (134B) (16.9R24) | TM600 | 438 | 1324 | 590 | 3970 | 625 | W15L | W14L - DW14L DW15L | TUBELESS | 16.9-24 TR218 |
| | 280/85R28 118A8 (115B) (11.2R28) | TM600 | 292 | 1187 | 542 | 3580 | 575 | W10 | W9 - DW10 | TUBELESS | 11.2/12.4-28 TR218 |
| | 320/85R28 124A8 (121B) (12.4R28) | TM600 | 329 | 1255 | 566 | 3796 | 600 | W11 | W10 - W9 - DW10 DW11 | TUBELESS | 12.4-28 TR218 |
| | 340/85R28 127A8 (124B) (13.6R28) | TM600 TM600 HD | 353 | 1289 | 595 | 3885 | 625 | W12 | W11 - DW11 - DW12 | TUBELESS | 13.6/12.4-28 TR218 |
| | 380/85R28 133A8 (130B) (14.9R28) | TM600 | 390 | 1357 | 615 | 4085 | 650 | W13 | W12 - W11 - DW11 DW12 - DW13 | TUBELESS | 14.9/16.9-28 TR218 |
| | 420/85R28 139A8 (136B) (16.9R28) | TM600 TM600 HD | 438 | 1425 | 635 | 4290 | 675 | W15L | W14L - DW14L DW15L | TUBELESS | 16.9-28 TR218 |
| NEW | 380/85R30 135A8 (135B) (14.9R30) | TM600* | 390 | 1408 | 635 | 4238 | 675 | W13 | W12 - W11 - DW11 DW12 - DW13 | TUBELESS | 14.9-30 TR218 |
| | 420/85R30 140A8 (137B) (16.9R30) | TM600 TM600 HD | 438 | 1475 | 660 | 4455 | 700 | W15L | W14L - DW14L DW15L | TUBELESS | 16.9/18.4-30 TR218 |
| | 420/90R30 147A8 (147B) | TM600 | 435 | 1518 | 691 | 4580 | 700 | DW13 | W13 - W14L - DW14L | TUBELESS | 18.4-30 TR218 |
| | 460/85R30 145A8 (142B) (18.4R30) | TM600 | 475 | 1544 | 691 | 4678 | 725 | W16L | W15L - DW15L DW16L | TUBELESS | 18.4-30 TR218 |
| | 380/85R34 137A8 (137B) (14.9R34) | TM600 | 390 | 1513 | 683 | 4574 | 725 | W12 | W13 | TUBELESS | 16.9-34 TR218 |
| | 380/85R34 142A8 (142B) (14.9R.3A) | TM600 | 390 | 1515 | | 4565 | 725 | W12 | W13 | TUBELESS | |
| | 420/85R34 142A8 (139B) (16.9R34) | TM600 | 438 | 1578 | 715 | 4745 | 750 | W15L | W14L - DW14L DW15L | TUBELESS | 16.9-34 TR218 |
| | 420/85R34 147A8 (147B) | TM600 | 445 | 1575 | 725 | 4735 | 750 | W15L | W14L - DW14L DW15L | TUBELESS | 16.9-34 TR218 |
| | 460/85R34 147A8 (144B) | TM600 | 475 | 1646 | 745 | 4945 | 775 | W16L | W15L - DW15L - DW16L | TUBELESS | 16.9/18.4-34 TR218 |
| | 320/85R38 129A8 (126B) (12.4R38) | TM600 | 325 | 1520 | 690 | 4605 | 725 | W11 | W10 - W9 - DW10 DW11 | TUBELESS | 12.4/16.9-38 TR218 |
| | 340/85R38 133A8 (130B) (13.6R38) | TM600 | 353 | 1543 | 710 | 4665 | 750 | W12 | W11 - DW11 DW12 | TUBELESS | 13.6/16.9-38 TR218 |
| | 380/80R38 142A8 (142B) | TM600 | 375 | 1575 | 724 | 4765 | 750 | W12 | W11 - W13 DW11 - DW12 - DW13 | TUBELESS | 14.9/16.9-38 TR218 |
| | 380/85R38 144A8 (144B) (14.9R38) | TM600 | 400 | 1610 | 730 | 4900 | 775 | W13 | W11 - W12 DW11 - DW12 - DW13 | TUBELESS | 16.9-38 TR218 |
| NEW | 380/95R38 147A8 (147B) Design data | TM600* | 390 | 1674 | 762 | 5020 | 800 | W12 | W13 | TUBELESS | |
| | 400/75R38 138A8 (135B) (15.5R38) | TM600 | 395 | 1565 | 707 | 4670 | 750 | DW14L | W14L | TUBELESS | |
| | 420/85R38 144A8 (141B) (16.9R38) | TM600 | 438 | 1679 | 760 | 5060 | 800 | W15L | W14L - DW14L DW15L | TUBELESS | 16.9-38 TR218 |
| NEW | 420/85R38 149A8 (149B) Design data | TM600* | 440 | 1665 | 766 | 5000 | 800 | W14L | DW14L - W15L DW15L | TUBELESS | |
| | 460/85R38 149A8 (146B) (18.4R38) | TM600 TM600 HD | 475 | 1747 | 800 | 5260 | 825 | W16L | W15L - DW15L DW16L | TUBELESS | 18.4-38 TR218 |
| NEW | 480/80R38 149A8 (149B) | TM600* | 495 | 1760 | 786 | 5325 | 825 | W16A | W15 - DW15 - DW16 | TUBELESS | |
| | 520/85R38 155A8 (152B) (20.8R38) | TM600 TM600 HD | 536 | 1849 | 825 | 5510 | 875 | DW18L | W16L - W18L DW16L | TUBELESS | 20.8-38 TR218 |
| NEW | 520/85R38 155A8 (152B) (20.8R38) | TM600* | 562 | 1849 | 820 | 5550 | 875 | DW18L | W16L - W18L - DW16L | TUBELESS | 20.8-38 TR218 |
| | 480/80R42 151A8 (151B) (18.4R42) | TM600 TM600 HD | 495 | 1850 | 833 | 5550 | 875 | W16A | DD16 - DW16B - DW16L | TUBELESS | 18.4/20.8-42 TR218 |
| | 520/85R42 157A8 (157B) (20.8R42) | TM600 TM600 HD | 536 | 1952 | 881 | 5867 | 925 | DW18L | W16L - W18L DW16L | TUBELESS | 20.8-42 TR218 |
| | 480/80R46 158A8 (158B) (18.4R46) | TM600 | 495 | 1964 | 887 | 5950 | 925 | W16A | DD16 - DW16B | TUBELESS | |
| | 520/85R46 158A8 (158B) (20.8R46) | TM600 | 535 | 2045 | 905 | 6160 | 975 | DW16L | W16L - W18L - DW16L DD16L - DD18L | TUBELESS | |
| NEW | 480/80R50 159D | TM600 | 500 | 2045 | 935 | 6190 | 975 | DW15B | DW16B | TUBELESS | |
| NEW | 480/80R50 159A8 (159B) (Design Data) | TM600 TM600 Rice | 490 | 2045 | | 6170 | | DW15B | | TUBELESS | |
| | 480/95R50 164A8 (164B) | TM600* | 500 | 2148 | 982 | 6490 | 1075 | DW16B | DW16A - DW15A - DW15B | TUBELESS | |

HD = Heavy Duty version
* = ProgressiveTraction version



Trelleborg is a world leader in engineered polymer solutions that seal, damp and protect critical applications in demanding environments. Our innovative engineered solutions accelerate performance for customers in a sustainable way. The Trelleborg Group has local presence in over 40 countries around the world.

WWW.TRELLEBORG.COM/WHEELS



facebook.com/TrelleborgAgri
twitter.com/TrelleborgWheel
youtube.com/TrelleborgAgri
flickr.com/TrelleborgAgri
linkedin.com/company/trelleborgwheelsystems
instagram.com/TrelleborgAgri



Trelleborg Wheel Systems Italia S.p.A.
Via Nazionale Tiburtina, 143 - 00010 Villa Adriana (RM) Italy
Phone: +39 0774 384701 - Fax: +39 0774 384702
www.trelleborg.com/wheels